

GENERAL NOTES

- 1/ OUR SPECIFICATIONS DATED JANUARY 2020 APPLY TO THIS PROJECT.
- 2/ THE WORKING WIDTH AVAILABLE TO THE CONTRACTOR TO CONSTRUCT THE NEW DRAINS SHALL CONSIST OF THOSE LANDS IMMEDIATELY ADJACENT TO THE DRAIN AND CONNECTIONS AND SHALL NOT EXCEED THE FOLLOWING AVERAGE WIDTHS:
 CLOSED PORTIONS
 - 8m CENTERED ON PIPE
 THE WORKING WIDTH FOR PURPOSES OF FUTURE MAINTENANCE SHALL BE THE SAME AS ABOVE.
- 3/ ALL OWNERS ALONG THE COURSE OF THE DRAIN SHALL MAKE AN ACCESS ROUTE FROM THE NEAREST ROAD TO THE DRAIN LOCATION AVAILABLE TO THE CONTRACTOR. THE AVERAGE WIDTH OF THIS ROUTE SHALL NOT EXCEED 8 METERS. THE ACCESS ROUTE SHALL ALSO APPLY FOR FUTURE MAINTENANCE PURPOSES.
- 4/ a) ALL UTILITIES TO BE LOCATED AND EXPOSED PRIOR TO CONSTRUCTION SO THAT THE NEW TILE GRADES CAN BE CONFIRMED. IF THERE IS A CONFLICT IN ELEVATION BETWEEN THE PROPOSED DRAIN AND THE UTILITY, THE ENGINEER IS TO BE NOTIFIED IMMEDIATELY.
 b) CONTRACTOR TO NOTIFY ALL UTILITIES 72 HOURS PRIOR TO HIS SCHEDULED TIME FOR STARTING THE ABOVE WORK.
 c) THE COST FOR THIS WORK SHALL BE INCLUDED IN THE ITEM ON THE EXTENT OF WORK AND NO EXTRA PAYMENT SHALL BE MADE TO THE CONTRACTOR, EXCEPT IF ROAD RESTORATION IS REQUIRED.
- 6/ CONTRACTOR TO ARRANGE A PRE-CONSTRUCTION MEETING WITH THE ENGINEER, DRAINAGE SUPERINTENDENT, AND THE AFFECTED OWNERS. ALL PARTIES SHALL RECEIVE 48 HOURS NOTICE TO THE MEETING.
- 7/ ALL PIPE TO CONFORM TO "SECTION C.1" IN THE SPECIFICATIONS.
 a) SEWER PIPE TO BE CONCRETE, H. D. P. E. PLASTIC 320 KPA (BELL & SPIGOT WITH RUBBER GASKETS, CONFORMING TO C.S.A. 1026-08)
- 8/ ALL CATCHBASINS SHALL BE SUPPLIED AND INSTALLED IN ACCORDANCE WITH "SECTION C.16" IN THE SPECIFICATIONS.
- 9/ NEW TILE DRAINS LOCATION AS SHOWN ON PLAN.
 EXISTING TILE DRAINS TO BE EXPOSED IN AS MANY LOCATIONS AS ARE NECESSARY TO CONFIRM THEIR EXACT LOCATION AND ELEVATION PRIOR TO CONSTRUCTION. EXACT LOCATION OF NEW TILE DRAINS THEN TO BE CONFIRMED BY DRAINAGE SUPERINTENDENT OR ENGINEER.
- 10/ a) INSTALLATION OF TILE AND TRENCH WIDTHS SHALL BE IN ACCORDANCE WITH "SECTION C - TILE DRAIN" IN THE SPECIFICATIONS.
 b) RESTORATION OF LAWN AREAS SHALL BE IN ACCORDANCE WITH "SECTIONS A.14 AND C.10" IN THE SPECIFICATION WITH THE FOLLOWING EXCEPTIONS:
 a) STRIP STOCKPILE AND REDISTRIBUTE TOPSOIL.
 b) TOPSOILED AREAS TO BE SEEDING IN ACCORDANCE WITH "SECTION A.14" IN THE SPECIFICATIONS.
 c) LANEWAY TO BE RESTORED TO ORIGINAL CONDITION IN ACCORDANCE WITH SPECIFICATIONS.

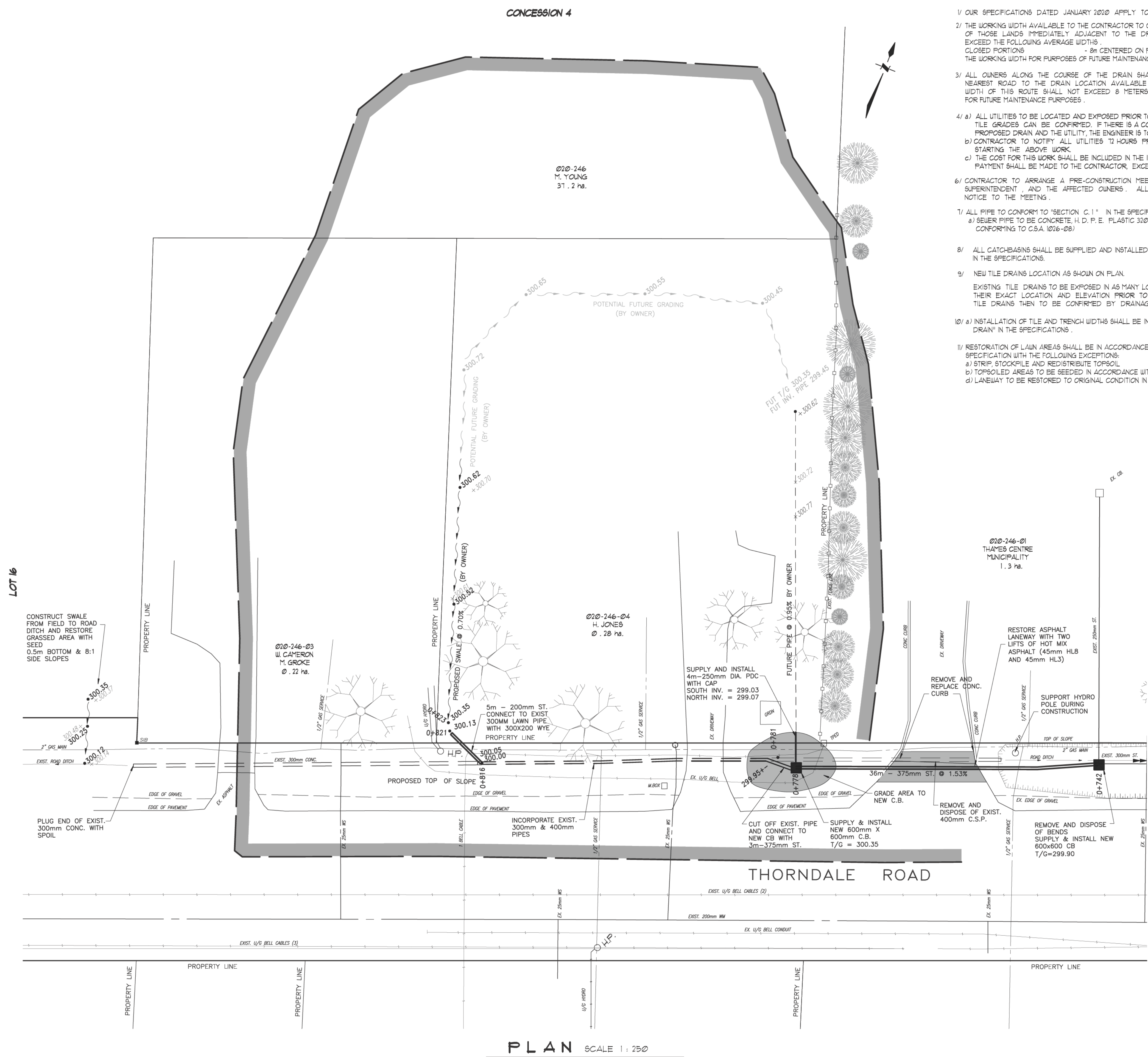
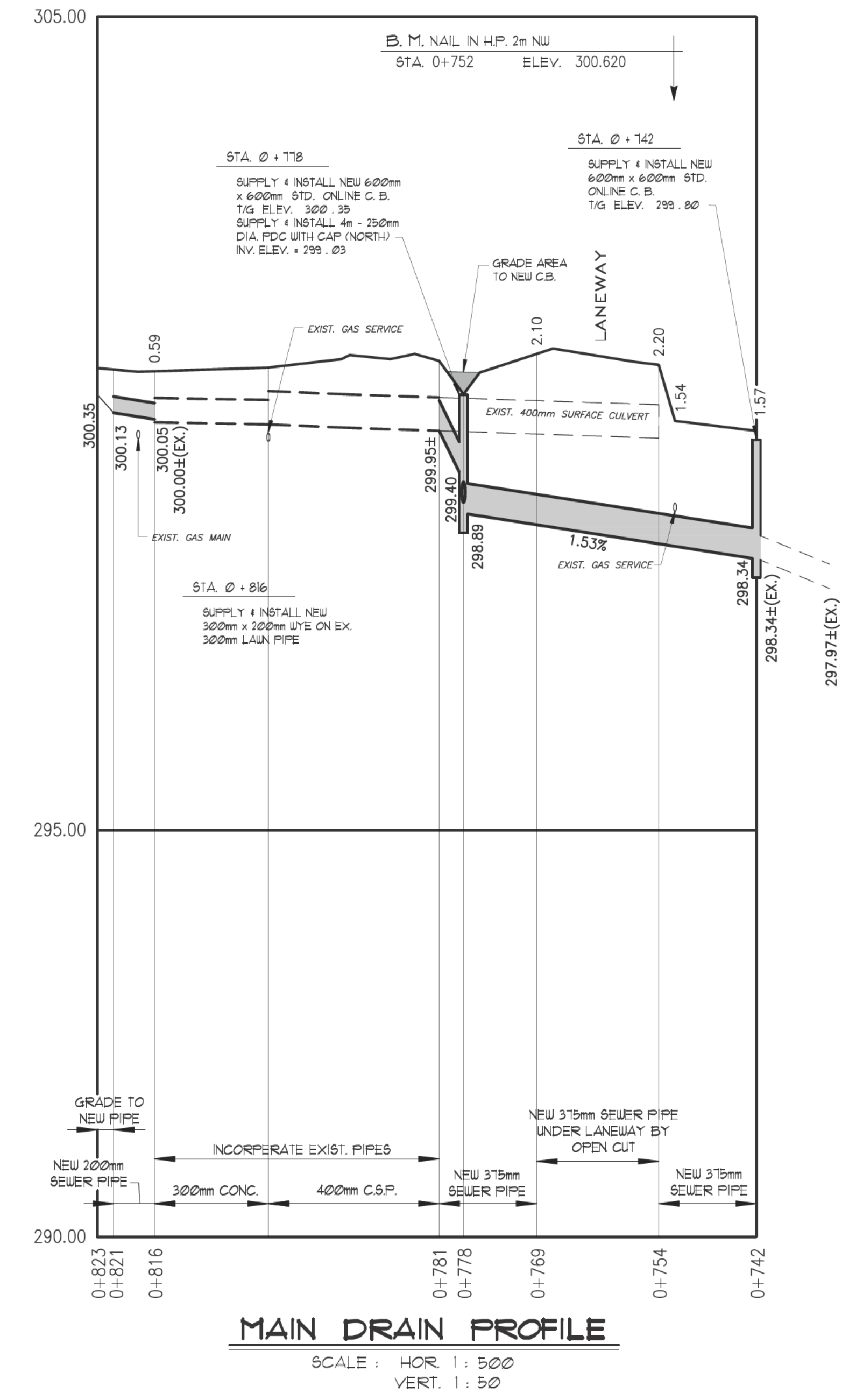

PLAN LEGEND

- LIMIT OF WATERSHED AREA
- PROPOSED DRAINAGE WORKS
- EXTERIOR OR INTERIOR WATERSHED
- TO BE INCLUDED FOR FUTURE MAINTENANCE
- EXIST. PRINCIPAL DRAIN
- PRIVATE TILE OR SURFACE WATER RUN
- EXIST. WATERCOURSE OR PRIVATE DITCH
- 10 - 023 ASSESSMENT ROLL NUMBER
 3 08111 OWNERS NAME
 40 8 ha. HECTARES OWNED
- BUSH AREA

ELLIOT DRAIN BRANCH "A" 2024

Municipality of Thames Centre

Drainage Superintendent: TRAVIS FITT 519-268-7334 EXT. 234	No.	REVISIONS	DATE
Drawn By: TF	Field Book	JOB No.	Drawing No.
Date: AUG 30, 2024	R. T. S.	2 2 3 2 2 4	1 of 1

DETAIL PLAN

SPRIET ASSOCIATES
 LONDON CONSULTING ENGINEERS LIMITED
 155 YORK STREET - LONDON (519) 672-4100 - NEA 1A8